



People who serve, products that solve.™

TM3-10H CONVEYOR TOASTER



Model TM3-10H in
Stainless Steel Finish

Style and consistent high quality output come together in the new TM3-10H Conveyor Toaster with Color Guard™ technology

Standard Features include:

- ▶ Color Guard™ system monitors the conveyor cavity temperature and instantly adjusts the conveyor speed to ensure toast uniformity especially in peak periods - to reduce wastage
- ▶ Power-save mode with indicator light saves energy during off-peak periods
- ▶ Bread and bun toast options mean more flexibility and customer satisfaction
- ▶ 390-460 slices per hour toast capacity for the busiest of venues
- ▶ 76.2mm opening height for a wide range of toasting requirements
- ▶ Built-in fan provides cool surface temperature maximising operator safety
- ▶ Stainless Steel standard with Black Designer colour optional. (Warm Red colour available to order).



Model TM3-10H in
Designer Black Finish

FSM (FOOD SERVICE MACHINERY PTY. LTD.)

HEAD OFFICE:

21-23 Agosta Drive, Laverton North,
Vic. 3026 Australia
T: +61 3 9368 2300 F: +61 3 9369 3800
E: sales@fsm-pl.com.au W: www.fsm-pl.com.au

SYDNEY OFFICE:

Unit 15, 7-9 Progress Circuit,
Prestons, NSW 2170
T: +61 2 9608 8620 F: +61 2 9607 9370
E: sales@fsm-pl.com.au W: www.fsm-pl.com.au

QUEENSLAND OFFICE:

4/40 Rivergate Place,
Murarie, QLD 4172
T: +61 7 3390 4185 F: +61 7 3393 9508
E: sales@fsm-pl.com.au W: www.fsm-pl.com.au

PERTH:

T: 0413 893 311
E: sales@fsm-pl.com.au
W: www.fsm-pl.com.au



**TOAST-MAX™
CONVEYOR TOASTER
Model TM3-10H SPECIFICATION**



SPECIFICATIONS

DIMENSIONS

338 W x 464 D x 411 mm H

OPENING HEIGHT

245 W x 76.2 mm H

CORD LOCATION

Left side of back of unit

CAPACITY

390–460 slices per hour

COLOR OPTIONS

Stainless Steel-Standard

Black-Optional

Warm Red-Optional

Supplied with 10A plug

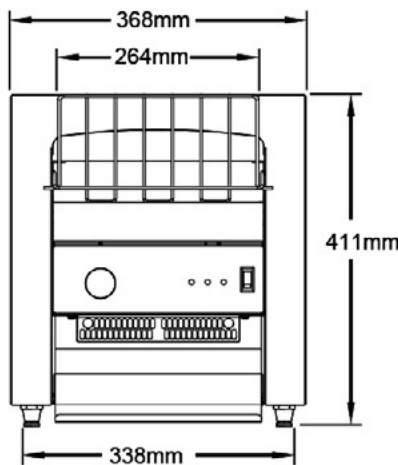

Front View

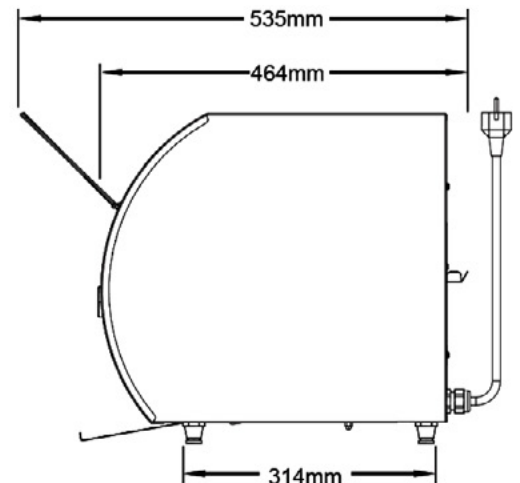

Side View

Model	Volts	Watt	Amps	Hz
TM3-10H	230V	2285W	9.5A	50-60Hz

Units are shipped with 25 mm adjustable legs, feed ramp, removable crumb tray and a discharge chute.
Ship Weight 19 kg.

Due to our policy of continuous product development, specifications and details are subject to change without notice. Call your nearest FSM Office for the latest information on this product.

FSM (FOOD SERVICE MACHINERY PTY. LTD.)

HEAD OFFICE:

21-23 Agosta Drive, Laverton North,
Vic. 3026 Australia
T: +61 3 9368 2300 F: +61 3 9369 3800
E: sales@fsm-pl.com.au W: www.fsm-pl.com.au

SYDNEY OFFICE:

Unit 15, 7-9 Progress Circuit,
Prestons, NSW 2170
T: +61 2 9608 8620 F: +61 2 9607 9370
E: sales@fsm-pl.com.au W: www.fsm-pl.com.au

QUEENSLAND OFFICE:

4/40 Rivergate Place,
Murarrie, QLD 4172
T: +61 7 3390 4185 F: +61 7 3393 9508
E: sales@fsm-pl.com.au W: www.fsm-pl.com.au

PERTH:

T: 0413 893 311
E: sales@fsm-pl.com.au
W: www.fsm-pl.com.au