

M2

Passthrough Dishwasher

STARLINE

by **WASHTECH**



STANDARD FEATURES

- 1, 2 and 3 minute cycles
- Touchscreen controls with versatile installation options
- 1.0HP soft start wash pump
- Dual chemical pumps
- Dual mode boiler plus rinse booster pump
- Hands-free drainage system with sump and drain pump
- Two-stage stainless steel wash and drain filtration
- Heavy-duty stainless-steel construction and manifold
- Independent stainless-steel wash and rinse arms
- Upgradable boiler for sites with low temp/flow water
- Updatable power for rapid rinse recovery
- Compatible with 595mm to 640mm benchgaps

- 1x 500mm dish rack (600 70028)
- 1x 500mm cup rack (600 70029)
- 1x cutlery container (C660503)

SPECIFICATIONS

A - Hot Water

Temperature	65°C*
Connection	3/4" male, hose supplied
Pressure	100-350kPa
Flow	20L per minute*
Backflow prevention	Atmospheric vacuum breaker
Consumption	2.4L per cycle

D - Drainage

Drain pump flexi-hose	25mm
-----------------------	------

C - Electrical

V	Hz	A/ph	Max kW
Single phase 230	50	15	3.25
Single phase 230	50	25	5.75
Three phase 400	50	15	7.50/9.75**

*Suitable for connection to cold and/or low flow water supplies, speak with your installer regarding optimal power and boiler configuration.

**To access full power on 3p, turn off wash/rinse heating element interlock. Isolating switch must be within 1m of, and not directly behind, the machine. Refer to operator manual for installation instructions.

In line with policy to continually develop and improve its products, Washtech reserves the right to change specifications and design without notice.

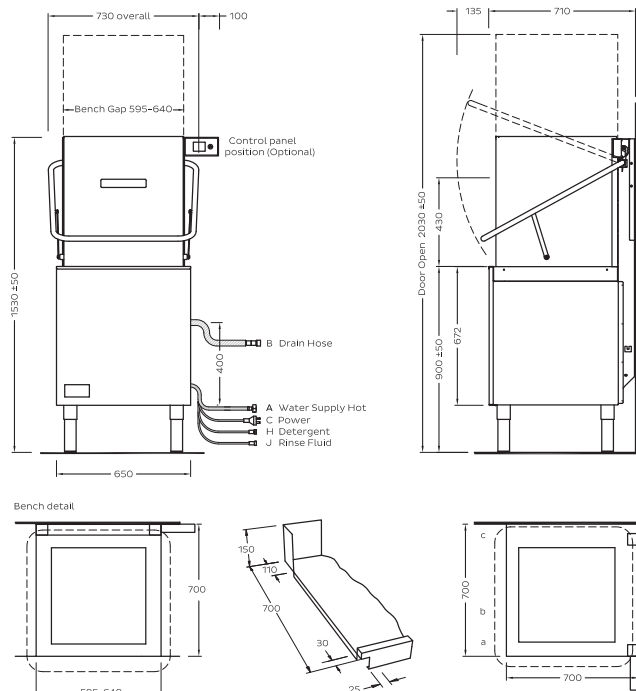

Dimensions

	Machine	Packed
Width (mm)	730	760
Depth (mm)	710	820
Height (mm)	1530	1460
Weight (kg)	94	125
Volume (m3)		0.91

Water Quality

	Min	Max
pH	7	8
Hardness	20	100
Cl-		100
SO4		400
Fe		0.1
Mn		0.5
Cu		0.05
Cl2		0.1

Corner Installation Notes:

- Machine can be installed either direction, subject to suitable position for controls.
- Allow 300mm clearance to front for service access.
- Splashback return to be no higher than 150mm.

Touchscreen Control:

- Bracket supplied with controls enables install either side, under bench or on wall.
- Consult Operator Manual for full details on correct installation.